



Metallbau Schwindl GmbH

Highest efficiency in steel and metal engineering –
with HiCAD towards a consistent workflow

Since 2014, Metallbau Schwindl GmbH has stood for versatility and flexibility in steel and metal engineering. The company carries out projects for public and private multi-story residential construction as well as for industrial and commercial construction. With a wealth of experience and expertise, the team has made a name for itself – from small flame-cut parts to complex steel engineering projects worth half a million euros.

However, in order to continue growing and meet increasing demands, the company sought a modern CAD solution in 2019 that could do more than just design.



REFERENCE REPORT



The initial situation: many tools, little consistency

Until then, all design tasks had been carried out using AutoCAD or BricsCAD. This worked, but it was not ideal.

“We wanted **a single program that could do everything**,” explains the design engineer. “From **designing** and **scan processing** to **automatic drawing derivation**.” The goal was clear: to work more efficiently while creating a modern working environment. The versatility of HiCAD immediately impressed the team. And there was even an added bonus: thanks to the “DigitalBonus Bayern”, the investment was additionally subsidized – a welcome side effect.

The decision to go with HiCAD was made quickly. Alternative software solutions were evaluated, but they couldn't keep up. “HiCAD was simply the best fit for our portfolio,” says the design engineer.

He describes the introduction itself as “jumping in at the deep end.” A week-long training course formed the basis, and the team mastered the rest through learning by doing – aided by the support team of the ISD.

Acceptance within the company was high: “HiCAD was instantly very well received by everyone.”

HiCAD in use: from point clouds to production drawings

Today, almost every project runs entirely in HiCAD – from the initial measurement to production:

1. Measurement via FARO scan
2. Inventory recording directly in HiCAD thanks to the **Point Cloud** module
3. First draft & drawing approval
4. Coordination with customers, architects, and structural engineers
5. Automatic drawing derivation for production planning
6. Export of DXF and NC files for cutting systems

Particularly popular in everyday use: working directly with point clouds, the steel engineering functions, the staircase configurator and the railing configurator.

“In the past, we had to do many steps manually.

Today, we can **process scans directly** and **automatically derive drawings** – this doesn't necessarily save time, but it significantly increases the quality and accuracy of our planning.”

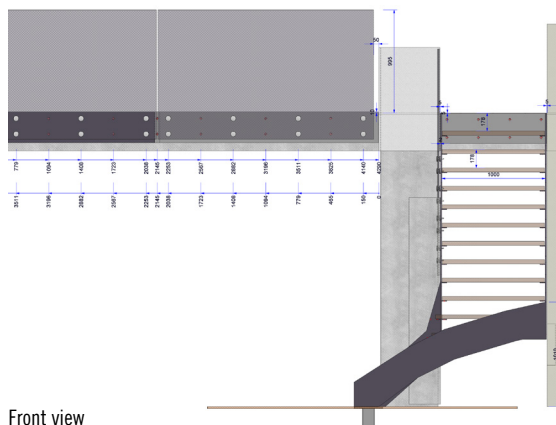

Front view

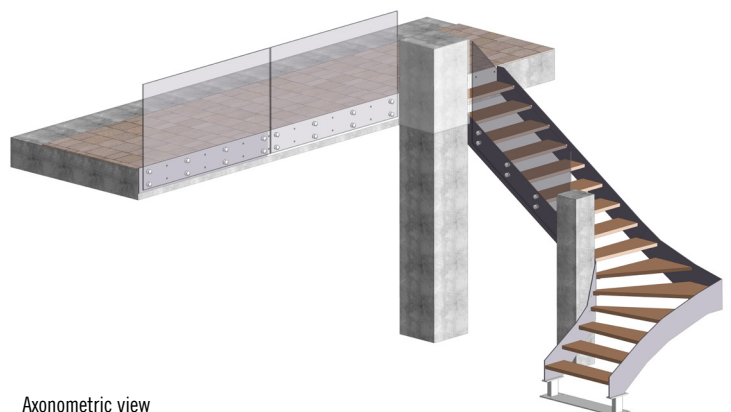

Axonometric view

The greatest advantage: a system that connects everything

HiCAD has now established itself as a **central platform**.

"We used to have several programs in use. Now, we have one system with many interfaces that works seamlessly with our processes and machines, which is a much better solution."

The benefits:

- Better visual representation and communication with customers
- Higher quality of production documents
- Greater clarity in projects
- More efficient and modern working methods

Even though the increase in efficiency is difficult to measure in figures, the difference is noticeable: "Today, we are working at a consistently **higher level of quality** and can **realise more complex projects**."

Projects: from individual parts to large and complex objects

Whether it's a single flame-cut part for one euro or a large project worth 500,000 euros, HiCAD supports the company every day with projects of all sizes. "**We only produce highlights**," says the design engineer with a smile.

A typical workflow shows how seamlessly HiCAD is integrated: from the first scan to the finished NC file, everything remains in the same system. This reduces sources of error and speeds up coordination with architects and structural engineers.

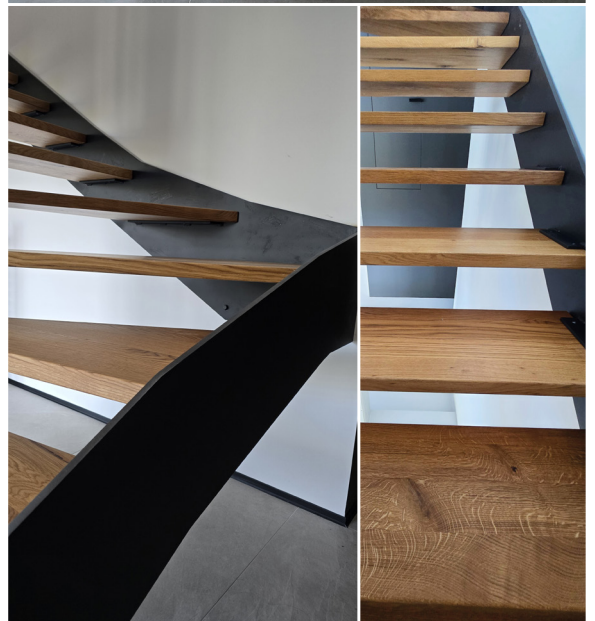

"If you are looking for a highly flexible system that can do everything from scanning to manufacturing, HiCAD is exactly the right choice."

Metallbau Schwindl GmbH

Conclusion: HiCAD has become indispensable

HiCAD has long been an integral part of everyday work.

"We use it **consistently and daily** — that says a lot," summarizes the design engineer.

His recommendation to other companies is clear:

"If you are looking for a highly flexible system that can do **everything** from scanning to manufacturing, HiCAD is exactly the right choice."

In brief:

- > Metallbau Schwindl GmbH
- > Industry: Steel/metal engineering, sheet metal
- > Software: HiCAD
- > ts@schwindl-metallbau.de

Image: ©Metallbau Schwindl GmbH



Your strong partner for your success!

See for yourself what our solutions can do. We would be delighted to show you the advantages of our software solutions in a personal presentation. Contact us to arrange an individual appointment – we are looking forward to meeting you!

ISD Software und Systeme GmbH

Tel.: +49-(0)231-9793-0

Mail: info@isdgroup.com

Web: www.isdgroup.com